



**SVENSK VÄRME**

## **PÅSFILTER SV-BFH**

**PÅSFILTERHUS I ROSTFRITT STÅL 304/316**





SVENSK VÄRME

TEKNISK DATA

YTTRE FILTERHUS:  
INVÄNDIG KORG

ROSTFRITT STÅL AISI 304 / AISI 316  
ROSTFRITT STÅL STAINLESS STEEL AISI 316

HÅLDIAMETER KORG:  
AVLUFTNINGSVENTIL:  
MAX ARBETSTRYCK:  
FÖRSLUTNING:

Ø 3mm  
Ø 1/2"  
8 bar  
Klamma

MODELL TYPE	DIMENSIONER								INVÄNDIG KORG INTERNAL BASKETS		ANSLUTNINGAR CONNECTIONS		FLÖDE FLOW RATE M3/h *	VIKT WEIGHT Kg
	A	B	C	D	E	F	G	H	N.	STL / SIZE	IN	OUT		
SV-BFH 114-1M SS304/1 1-4	114,3	317,1	387,5	443,5					1	STL 1M - Ø100,5 x 210,5	1" 1/4	1" 1/4	13	4,5
SV-BFH 114-2M SS304/1 1-4	114,3	457,1	527,5	583,5					1	STL 2M - Ø100,5 x 350,5	1" 1/4	1" 1/4	13	5,8
SV-BFH 114-1M SS316/1 1-4	114,3	317,1	387,5	443,5					1	STL 1M - Ø100,5 x 210,5	1" 1/4	1" 1/4	13	4,5
SV-BFH 114-2M SS316/1 1-4	114,3	457,1	527,5	583,5					1	STL 2M - Ø100,5 x 350,5	1" 1/4	1" 1/4	13	5,8
SV-BFH 219-1 SS304/2	219,1	1112	896	300	1013	287			1	STL 1 - Ø180 x 400	2"	2"	30	17
SV-BFH 219-2 SS304/2	219,1	1445	1226	300	1343	287			1	STL 2 - Ø180 x 770	2"	2"	30	22
SV-BFH 219-1 SS316/2	219,1	1112	896	300	1013	287			1	STL 1 - Ø180 x 400	2"	2"	30	17
SV-BFH 219-2 SS316/2	219,1	1445	1226	300	1343	287			1	STL 2 - Ø180 x 770	2"	2"	30	22
SV-BFH 250-1 SS304/2	252	954	735	175	825	320			1	STL 1 - Ø180 x 400	2"	2"	30	15
SV-BFH 250-2 SS304/2	252	1324	1110	175	1195	320			1	STL 2 - Ø180 x 770	2"	2"	30	20
SV-BFH 250-1 SS304/Dn65	252	954	735	145	825	191,5			1	STL 1 - Ø180 x 400	Dn65	Dn65	36	18,5
SV-BFH 250-2 SS304/Dn65	252	1324	1110	145	1195	191,5			1	STL 2 - Ø180 x 770	Dn65	Dn65	36	23,5
SV-BFH 250-1 SS304/Dn80 Duplex	252	954	735	340	825	191,5			2	STL 1 - Ø180 x 400	Dn80	Dn80	40	58
SV-BFH 250-2 SS304/Dn80 Duplex	252	1324	1110	340	1195	191,5			2	STL 2 - Ø180 x 770	Dn80	Dn80	40	65,5
SV-BFH 250-1 SS304/Dn80 Dual flow	252	954	735	340	825	191,5			2	STL 1 - Ø180 x 400	Dn80	Dn80	75	51
SV-BFH 250-2 SS304/Dn80 Dual flow	252	1324	1110	340	1195	191,5			2	STL 2 - Ø180 x 770	Dn80	Dn80	75	59
SV-BFH 250-1 SS316/2	252	954	735	175	825	320			1	STL 1 - Ø180 x 400	2"	2"	30	15
SV-BFH 250-2 SS316/2	252	1324	1110	175	1195	320			1	STL 2 - Ø180 x 770	2"	2"	30	20
SV-BFH 250-1 SS316/Dn65	252	954	735	145	825	191,5			1	STL 1 - Ø180 x 400	Dn65	Dn65	36	18,5
SV-BFH 250-2 SS316/Dn65	252	1324	1110	145	1195	191,5			1	STL 2 - Ø180 x 770	Dn65	Dn65	36	23,5
SV-BFH 250-1 SS316/Dn80 Duplex	252	954	735	340	825	191,5			2	STL 1 - Ø180 x 400	Dn80	Dn80	40	58
SV-BFH 250-2 SS316/Dn80 Duplex	252	1324	1110	340	1195	191,5			2	STL 2 - Ø180 x 770	Dn80	Dn80	40	65,5
SV-BFH 250-1 SS316/Dn80 Dual flow	252	954	735	340	825	191,5			2	STL 1 - Ø180 x 400	Dn80	Dn80	75	51
SV-BFH 250-2 SS316/Dn80 Dual flow	252	1324	1110	340	1195	191,5			2	STL 2 - Ø180 x 770	Dn80	Dn80	75	59
SV-BFH 450-1 SS304/Dn100	450	1126	807	514	971	610	750	1406	3	STL 1 - Ø180 x 400	Dn100	Dn100	112	73
SV-BFH 450-2 SS304/Dn100	450	1496	1177	514	1341	610	750	1776	3	STL 2 - Ø180 x 770	Dn100	Dn100	112	93
SV-BFH 450-1 SS316/Dn100	450	1126	807	514	971	610	750	1406	3	STL 1 - Ø180 x 400	Dn100	Dn100	112	73
SV-BFH 450-2 SS316/Dn100	450	1496	1177	514	1341	610	750	1776	3	STL 2 - Ø180 x 770	Dn100	Dn100	112	93
SV-BFH 508-1 SS304/Dn125	508	1203	843	504	1032	668	821	1529	4	STL 1 - Ø180 x 400	Dn 125	Dn 125	130	79
SV-BFH 508-2 SS304/Dn125	508	1573	1213	504	1402	668	821	1899	4	STL 2 - Ø180 x 770	Dn 125	Dn 125	130	95
SV-BFH 508-1 SS304/Dn150	508	1203	843	504	1032	668	821	1529	4	STL 1 - Ø180 x 400	Dn 150	Dn 150	150	81
SV-BFH 508-2 SS304/Dn150	508	1573	1213	504	1402	668	821	1899	4	STL 2 - Ø180 x 770	Dn 150	Dn 150	150	97



SVENSK VÄRME

MODELL TYPE	DIMENSIONER									INVÄNDIG KORG INTERNAL BASKETS		ANSLUTNINGAR CONNECTIONS		FLÖDE FLOW RATE M3/h *	VIKT WEIGHT Kg
	A	B	C	D	E	F	G	H	N.	STL / SIZE	IN	OUT			
SV-BFH 508-1 SS316/Dn125	508	1203	843	504	1032	668	821	1529	4	STL 1 - Ø180 x 400	Dn 125	Dn 125	130	79	
SV-BFH 508-2 SS316/Dn125	508	1573	1213	504	1402	668	821	1899	4	STL 2 - Ø180 x 770	Dn 125	Dn 125	130	95	
SV-BFH 508-1 SS316/Dn150	508	1203	843	504	1032	668	821	1529	4	STL 1 - Ø180 x 400	Dn 150	Dn 150	150	81	
SV-BFH 508-2 SS316/Dn150	508	1573	1213	504	1402	668	821	1899	4	STL 2 - Ø180 x 770	Dn 150	Dn 150	150	97	
SV-BFH 600-1 SS304/Dn150	600	1219	843	525	1032	800	940	1627	5	STL 1 - Ø180 x 400	Dn 150	Dn 150	150	127	
SV-BFH 600-2 SS304/Dn150	600	1589	1213	525	1402	800	940	1997	5	STL 2 - Ø180 x 770	Dn 150	Dn 150	150	161,5	
SV-BFH 600-1 SS316/Dn150	600	1219	843	525	1032	800	940	1627	5	STL 1 - Ø180 x 400	Dn 150	Dn 150	150	127	
SV-BFH 600-2 SS316/Dn150	600	1589	1213	525	1402	800	940	1997	5	STL 2 - Ø180 x 770	Dn 150	Dn 150	150	161,5	
SV-BFH 700-1 SS304/Dn200	700	1372	945	620	1154	900	1035	1840	7	STL 1 - Ø180 x 400	Dn 200	Dn 200	200	145	
SV-BFH 700-2 SS304/Dn200	700	1742	1315	805	1524	900	1035	2210	7	STL 2 - Ø180 x 770	Dn 200	Dn 200	200	168,5	
SV-BFH 700-1 SS316/Dn200	700	1372	945	620	1154	900	1035	1840	7	STL 1 - Ø180 x 400	Dn 200	Dn 200	200	145	
SV-BFH 700-2 SS316/Dn200	700	1742	1315	805	1524	900	1035	2210	7	STL 2 - Ø180 x 770	Dn 200	Dn 200	200	168,5	
SV-BFH 900-2 SS304/Dn250	900	1852	1341	763	1605	1200	1271	2493	9	STL 2 - Ø180 x 770	Dn 250	Dn 250	300	273,5	
SV-BFH 900-2 SS304/Dn300	900	1852	1341	763	1605	1200	1271	2493	9	STL 2 - Ø180 x 770	Dn 300	Dn 300	500	282	
SV-BFH 900-2 SS316/Dn250	900	1852	1341	763	1605	1200	1271	2493	9	STL 2 - Ø180 x 770	Dn 250	Dn 250	300	273,5	
SV-BFH 900-2 SS316/Dn300	900	1852	1341	763	1605	1200	1271	2493	9	STL 2 - Ø180 x 770	Dn 300	Dn 300	500	282	
SV-BFH 1100-2 SS304/Dn300	1100	1978	1419	841	1683	1400	1516	2782	15	STL 2 - Ø180 x 770	Dn 300	Dn 300	500	509	
SV-BFH 1100-2 SS304/Dn350	1100	1978	1419	841	1683	1400	1516	2782	15	STL 2 - Ø180 x 770	Dn 350	Dn 350	600	522	
SV-BFH 1100-2 SS316/Dn300	1100	1978	1419	841	1683	1400	1516	2782	15	STL 2 - Ø180 x 770	Dn 300	Dn 300	500	509	
SV-BFH 1100-2 SS316/Dn350	1100	1978	1419	841	1683	1400	1516	2782	15	STL 2 - Ø180 x 770	Dn 350	Dn 350	600	522	

\* /Flöde utan påse / Flow delivery without bag. / Æp 0,2 Bar

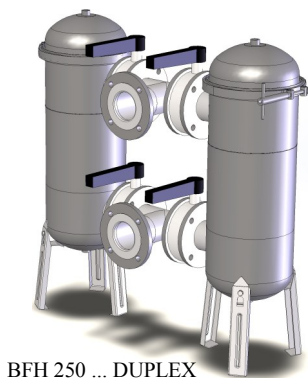

BFH 250 ... DUPLEX

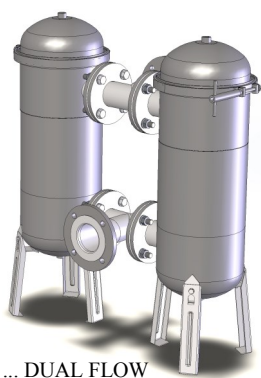

BFH 250 ... DUAL FLOW

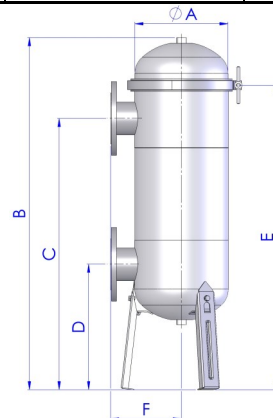

Serie 250...Duplex / Dual Flow

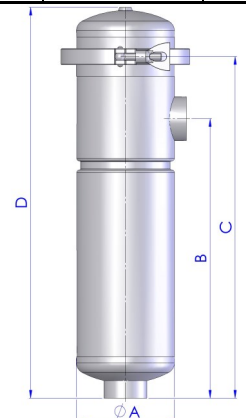

Serie 114

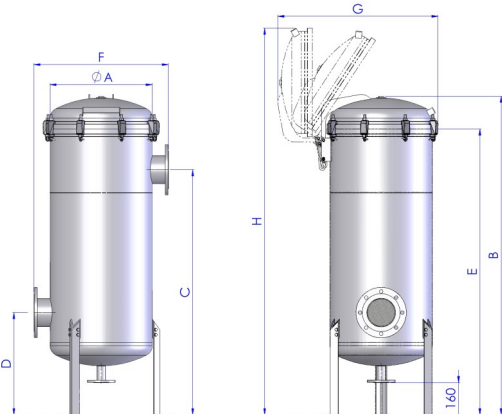

Serie 450...1100

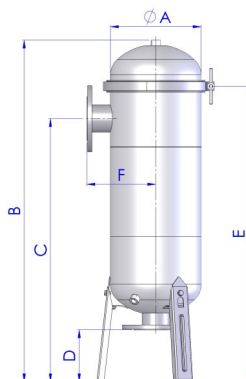

Serie 250...Dn65

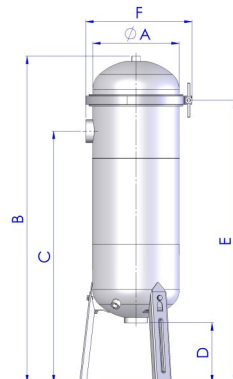

Serie 250...2

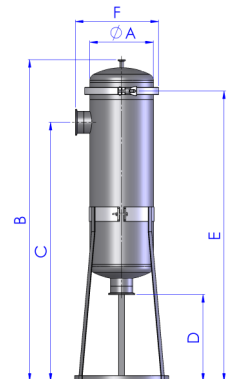

Serie 219



SVENSK VÄRME

Påsfiler, tillverkad av AISI 304 eller AISI 316 Rostfritt stål, kan hålla standard, storlek 1M, 2M, 1 e 2. Varje påsehållarekorg har en O-ring och handtag, med en enkel anordning garanteras perfekt tätning mellan korg och påse. De är speciellt lämpade för filtrering av vätskor med en hög andel suspenderade fastämnen, rost, magnetit samt för färger, oljor etc. Filterpåsen, finns i flertal filtrerings- grader i polypropen, nylon och polyester.

FILTER BAG filters, made of AISI 304 or AISI 316 Stainless Steel, can hold standard, size 1M, 2M, 1 e 2. Any bag-holder basket have an O-Ring and the handle, with a simple device, ensures perfect sealing on the basket and the bag. They are particularly suited for filtering liquids with a high percentage of suspended solids, for paints, oils, etc. The filter bags, filtering at va-rious degrees, are available in Polypropylene, Nylon and Polyester.

SV-BFH 114 och 219 modellerna kan levereras med intern finish Ra 0,8 µm och extern Ra 1,8 µm.

The BFH 114 and 219 models can be supplied internal finishing Ra 0,8 µm and external Ra 1,8 µm.

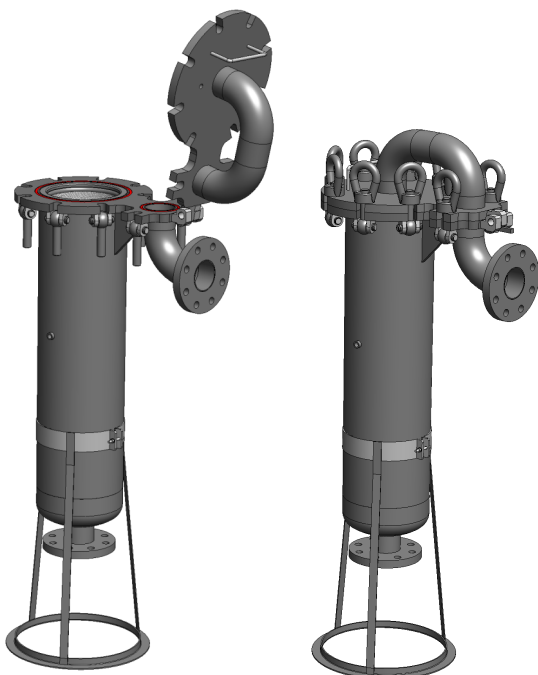

BFH 219 Topp ansl.tillval  
BFH 219 TOP INLET on required

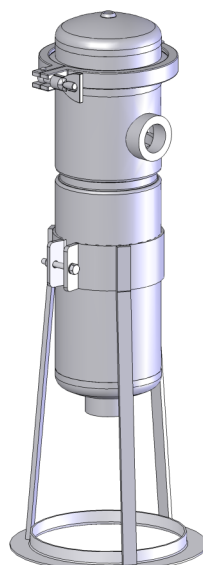

BFH 114 benstativ  
BFH 114 with legs

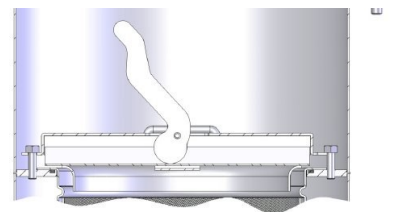

Klamma för pås tätning  
Clamp for bag

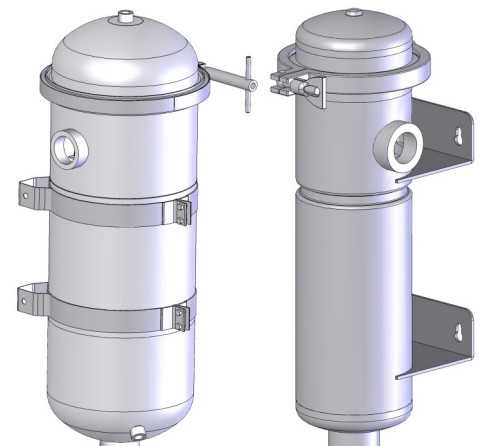

Väggfäste exempel( BFH 114 e 250)  
Wall brackets examples (BFH 114 and 250)





SVENSK VÄRME



## TILLBEHÖR / ACCESSORIES

Magnet karakteristik / Magnet Characteristic									
Kvalitet Quality	Kraft / Rest		Coercitivkraft / Coercitive force				Energiförbrukning/Energy consumption		Max temperatur Max working temp. °C
	Br		bHc		iHc		(BxH) max		
	Gauss (G)	Tesla (T)	kOe	kA/m	kOe	kA/m	MGOe	kJ/m <sup>3</sup>	
N35 *	11700	1,17	10,8	860	≥ 12	≥ 955	33	263	≤ 80
	12100	1,21	11,5	915			35	279	

\* Neodimio 35

Magnetstavar / Magnet rods			Magnet/ Magnets		Tub/ Pipe
			Ø x L*	N.º	Ø x L*
C98401000000000	Size 1M		15 x 100	2	18 x 221
C98402000000000	Size 1 e 2M		15 x 100	3	18 x 326
C98403000000000	Size 2		15 x 100	6	18 x 641

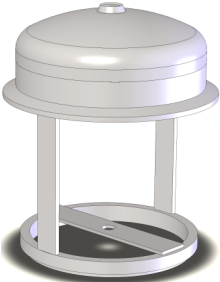
\*diameter x längd/ diameter x length

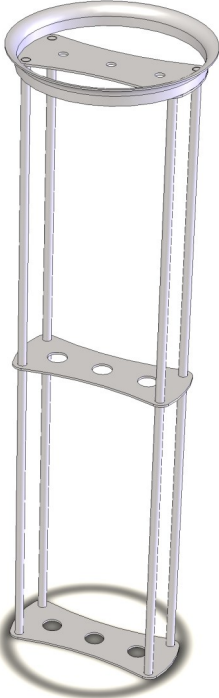
Stativ för magneter / Magnet			
	Size 1M e 2M	Size 1 C9742000000000	Size 2 C97430000000000
			
<b>Magnetstavar Magnet rods</b>	1	1 / 2 / 3	1 / 2 / 3



SVENSK VÄRME

## POLYPROPYLENE / POLYESTER / NYLON FILTER PÅSE/BAG

### Flödes tabell / Flow rate table

Max. cirka. Flödeshastighet för enstaka påsfilter storlek 1 med tryckfall (renpåsefilter) på 0,2 bar.

Max. approx. flow rate for single Bag Filters size 1 with initial drop in pressure ( clean Bag Filter) of 0.2 bar.

Filtreringsgrad i Micron Filtration degree in rated microns µm	Flöde H <sub>2</sub> O Ø 180x430h H <sub>2</sub> O rate for Ø 180x430h Bag Filter l/h	Konverteringsfaktor för media med viskositet annan än 1cps Conversion factor for liquids with viscosity other than 1 cps	
		Viskositet /Viscosity cps	Konvertering /Conversion factor
5	11000	200	0,85
15	18000	400	0,35
25	22000	600	0,25
50	26000	800	0,17
100	28000	1500	0,16
		1800	0,11
		2000	0,08
		4000	0,05
		6000	0,035
		8000	0,026
		10000	0,021

Flow rate size 2 = 2 x Flow rate Size 1 - Flow rate size 2M = 0,5 x Flow rate Size 1 - Flow rate size 1M = 0,25 x Rate Size 1

Material	Max Temp.	Aromatis Aromatic Solvents	Alifatic Solvents	Aqueous Solutions	SYRA Acids	Strong Stark Acids	Alkali	Strong Alkali	Vegetable Oils	Animal Oils
Polypropylen	90°C		•	•	•	•	•	•	•	•
Polyester	150°C	•	•	•	•	•	•		•	•
Nylon	135°C	•	•	•			•	•		

### Påse / Bags

Stl/Size		Flödes hastighet / Flow rate	Filteryta / Surface
Stl/Size 1M			0,05 m <sup>2</sup>
Stl/Size 2M			0,1 m <sup>2</sup>
Stl/Size 1			0,19 m <sup>2</sup>
Stl/Size 2			0,41 m <sup>2</sup>
Stl/Size 6			0,82 m <sup>2</sup>
Max-Pleated			
Stl/Size 1		Flödeshastighet ≈ 2 x Flödeshastighet 1Påse Flow rate ≈ 2 x Flow rate size 1 Bag	4,2 m <sup>2</sup>
Stl/Size 2		Flödeshastighet ≈ 4 x Flödeshastighet 1 Påse Flow rate ≈ 4 x Flow rate size 1 Bag	9,8 m <sup>2</sup>